

PROPOSED / EXISTING BUILDINGS OVERLAY

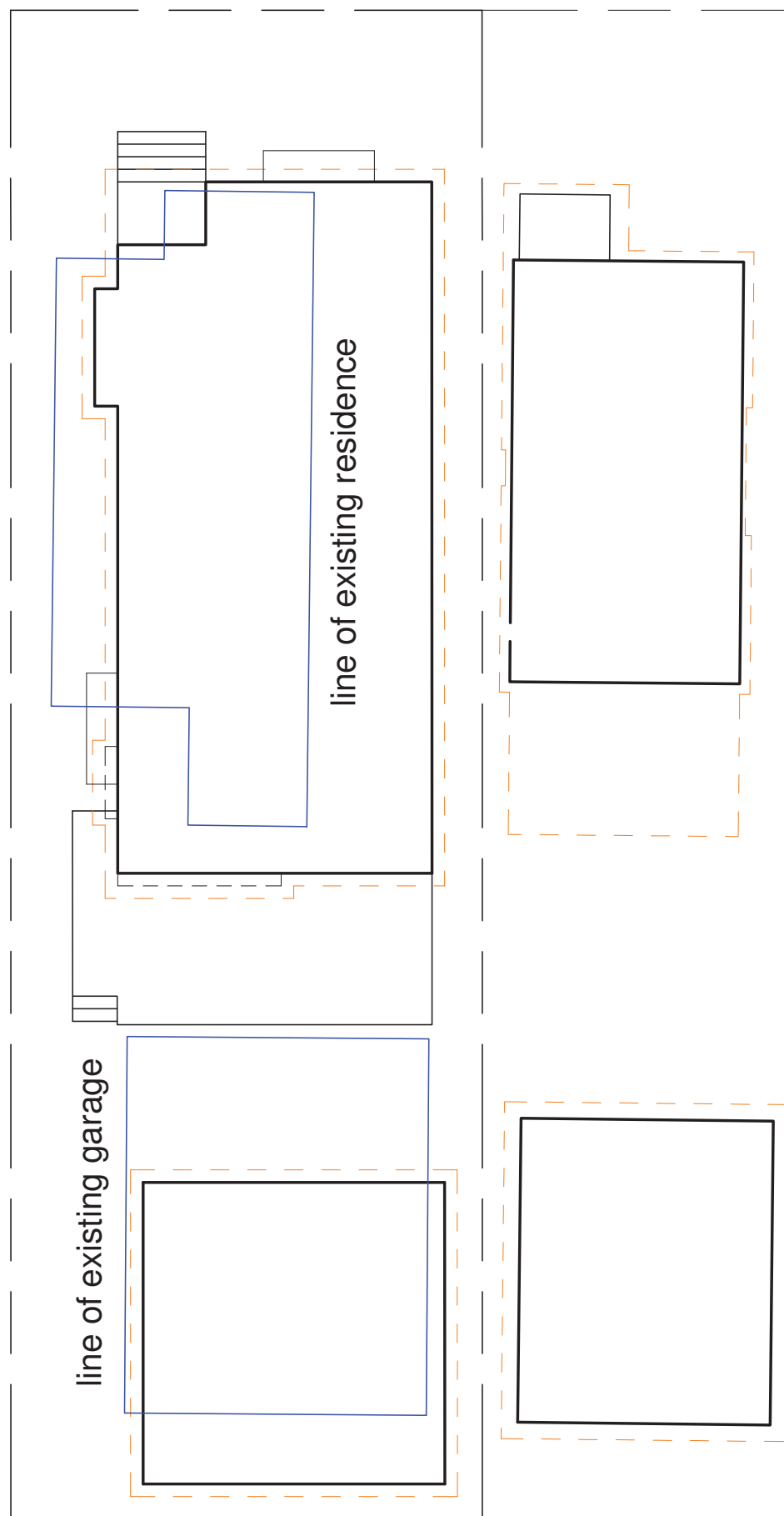
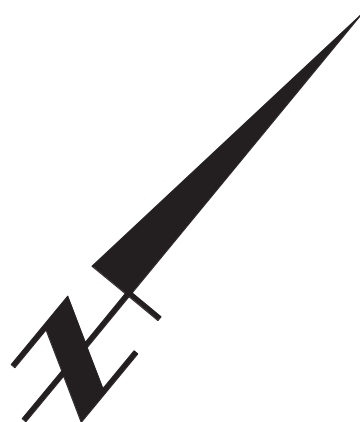

SCALE - 1 : 150

TOTAL LOT: _____
 TOTAL HOUSE: _____
 TOTAL GARAGE: _____
 % LOT COVERAGE: _____

**TWO CONTINUOUS 10M
 REBAR REQUIRED IN
 CONCRETE STRIP FOOTING**

YES NO

ADDRESS:

827 - 3 Avenue NW

PROJECT NUMBER:

LOT:

6&7

BLOCK:

10

PHASE:

1948 P

CUSTOMER NAME:

BOLLMAN

DRAWN BY:

M. k. M.

DATE:

March 5, 2018

MODEL:

New Detached Single-Family Dwelling



RENOVA
LUXURY HOMES

CLIENT NAME
BOLLMAN

CIVIC ADDRESS
827 - 3 Avenue NW

DATE
Feb. 27, 2018

REVISIONS / NOTES

DESIGNS / DRAWINGS ARE
COPYRIGHT PROPERTY OF
M. K. M. DESIGN INC., OKTOCKS, AB
ALL DIMENSIONS INDICATED
ARE FOR FRAMING PURPOSES AND
ARE TO BE CONFIRMED ON SITE

MODEL
**New Detached
Single-Family Dwelling**

AREA BREAKDOWN
CREB
MAIN:
UPPER:
TOTAL:
LOWER:
GARAGE:

DESIGNER
M. K. M.

SCALE
1 : 100

JOB NUMBER

SHEET

L - 1

TREE	DIAMETER	SPREAD	HEIGHT	TYPE	STATUS
1 SERIAL No. T32119340	0.80	4.0	8.5	POPLAR	REMAIN
2	-	3.5	2.5	BUSH	REMAIN
3 SERIAL No. T32119338	0.81	4.0	8.5	POPLAR	REMAIN
4	-	-	-	DECIDUOUS	NEW
5	-	-	-	BUSH	NEW
6	-	1.0	1.5	BUSH	REMAIN
7	0.08	1.5	2.5	DECIDUOUS	REMAIN
8	0.1	1.5	2.5	DECIDUOUS	REMAIN
9	0.5	3.0	5.0	DECIDUOUS	REMAIN
10	0.5	3.0	5.0	DECIDUOUS	REMAIN
11	-	-	-	DECIDUOUS	NEW
12	-	-	-	DECIDUOUS	NEW
13	-	-	-	DECIDUOUS	NEW
14	-	-	-	BUSH	NEW

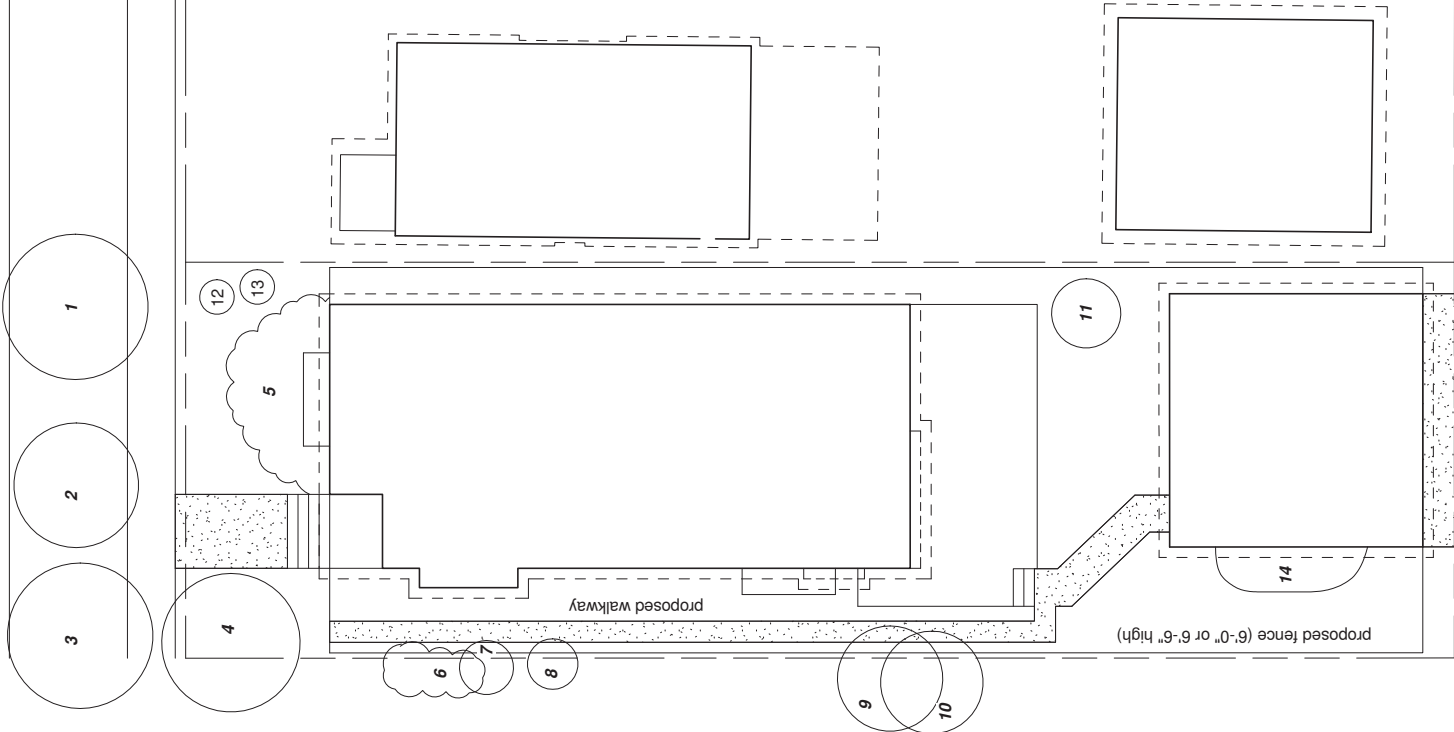
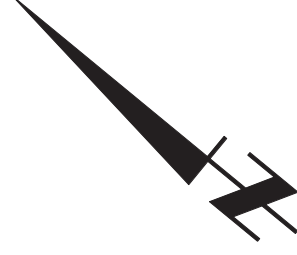

PRELIMINARY SET

PROPOSED LANDSCAPING PLAN